



Forming of complex aerostructures

13/04/2021

Claudia Jimenez Martin

Supervisors: Dr James Kratz (UoB) & Jon Wright (Airbus)

AIRBUS

The Problem Statement

- Aircraft production rates are increasing

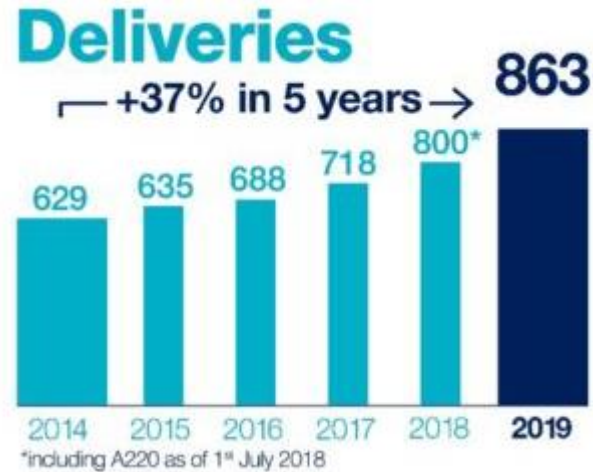

- Structures are more integrated

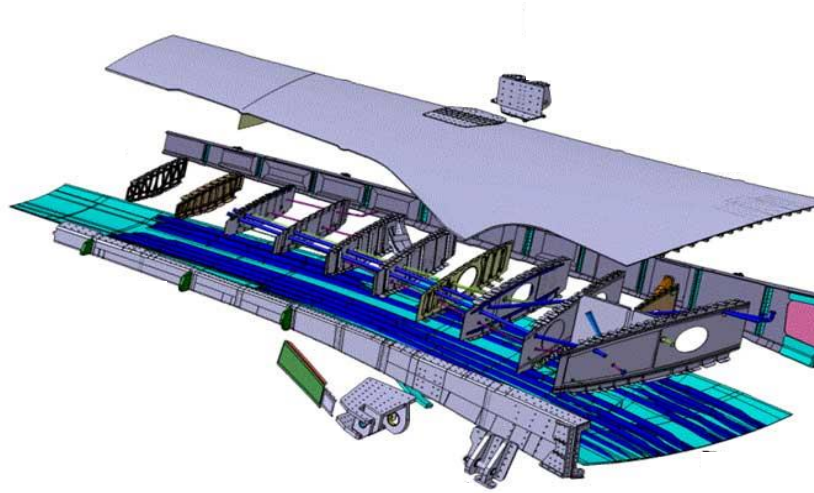

- Jet engines are larger

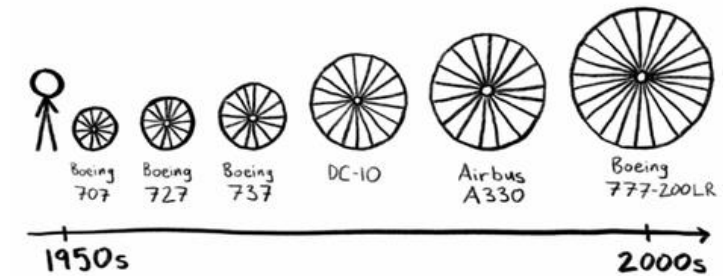

Complex shapes

The Preforming Bottleneck



- **Dry fibre processes offer** promising deposition rates.

- Preforming is **complex, step-intensive** and often **manual**
- **Defects such as ply wrinkling can occur.**



The Scale Dilemma

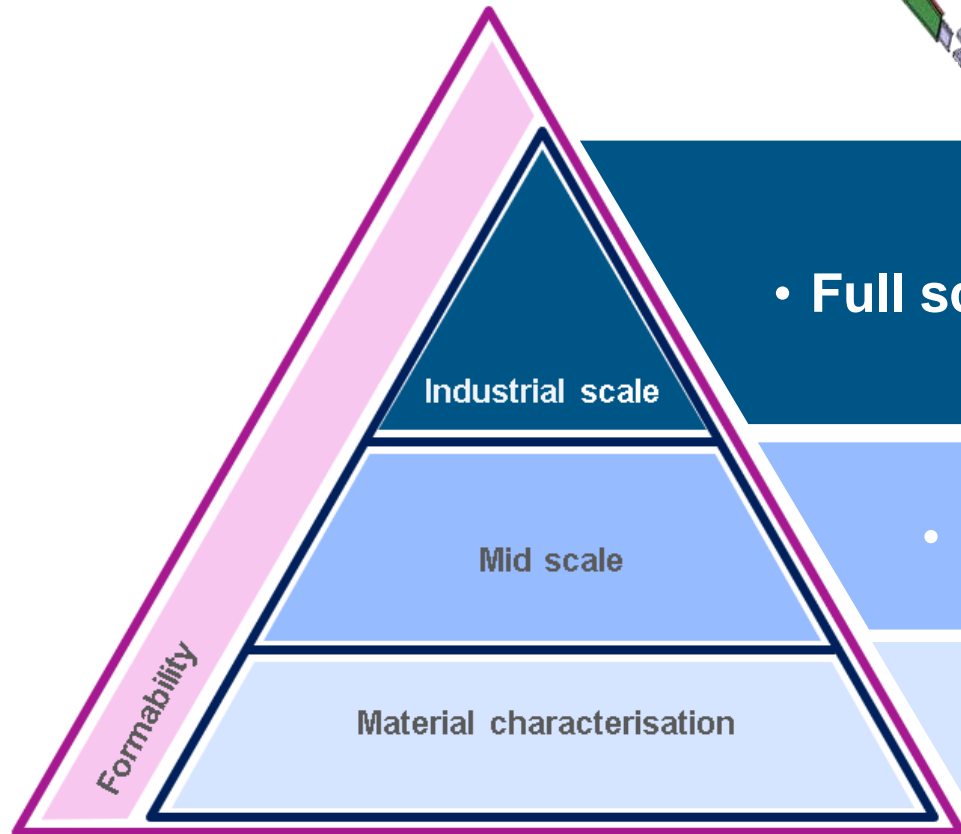
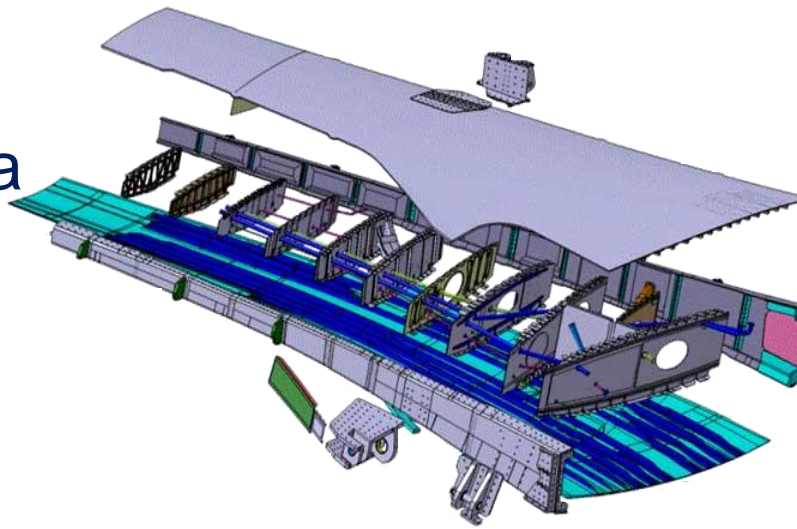

- Full scale component

- Component sections

- Bias extension / picture frame

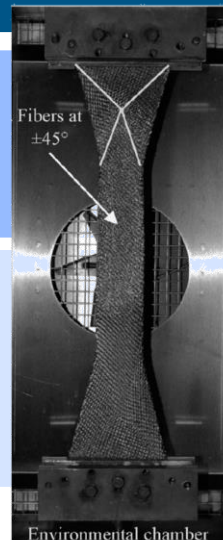

The Scale Dilemma

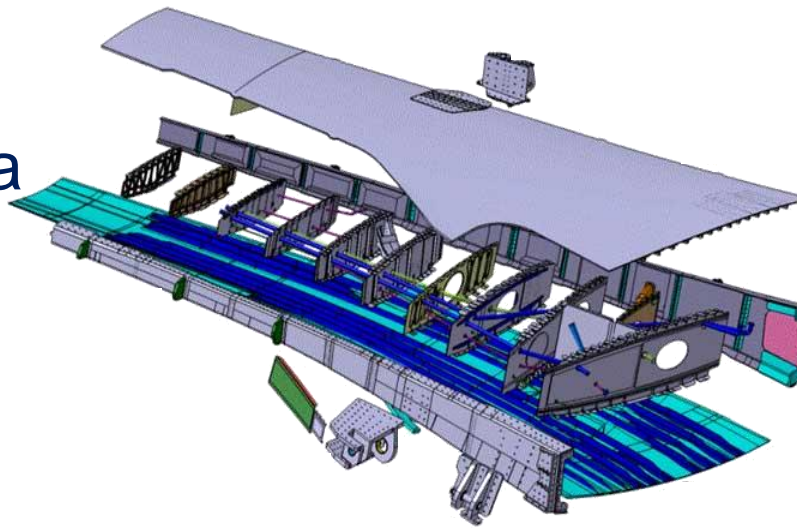

- Full scale component

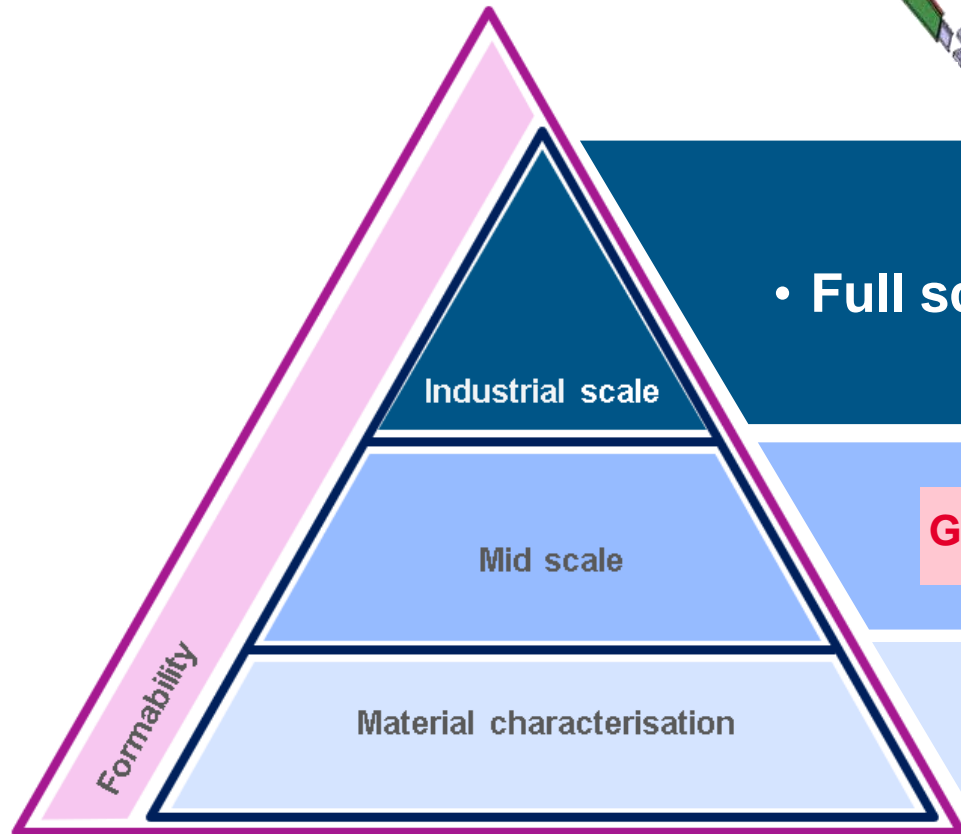

GLOBAL FEATURES NOT TESTED

INACCURATE BOUNDARY CONDITIONS

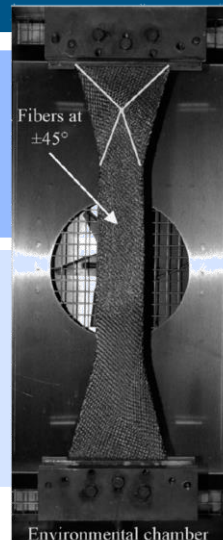

The Scale Dilemma

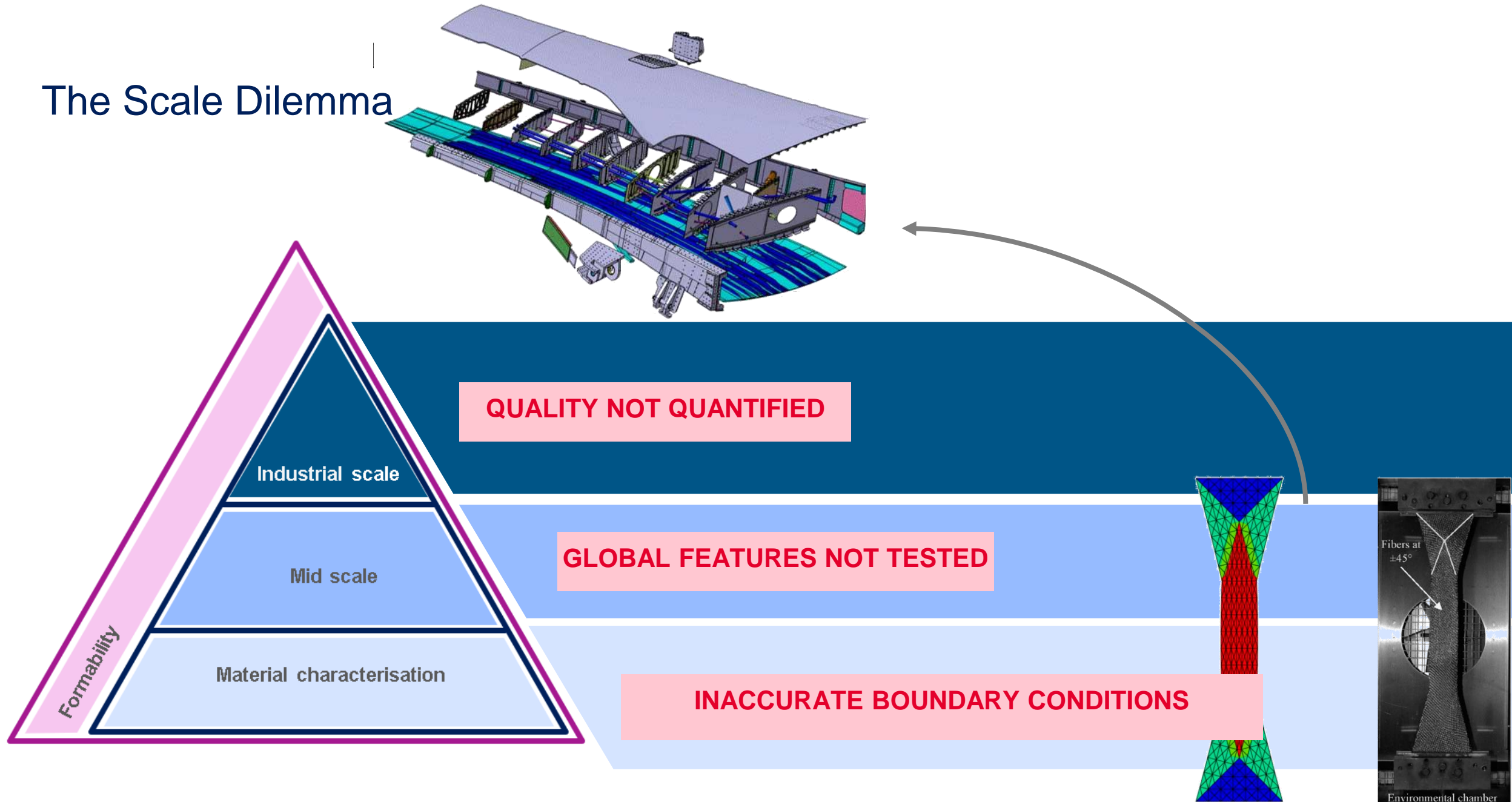

The Scale Dilemma

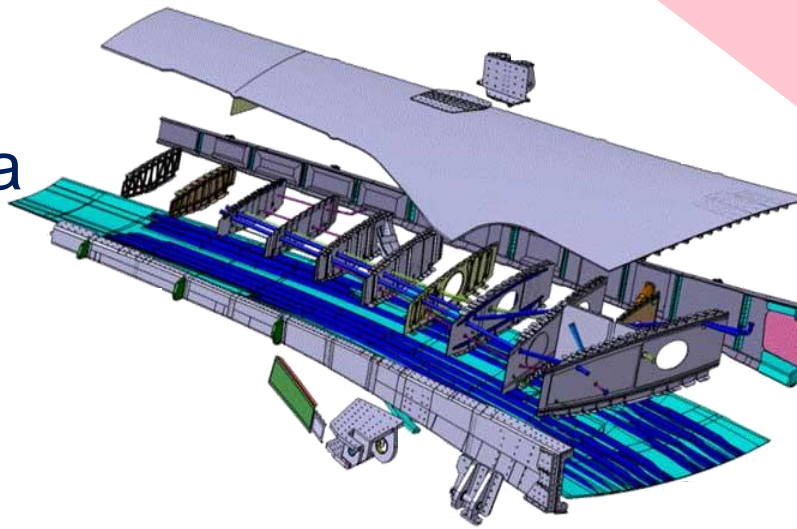

Targeted Outcome:

A DATA DRIVEN COMPARISON
ACROSS SCALES

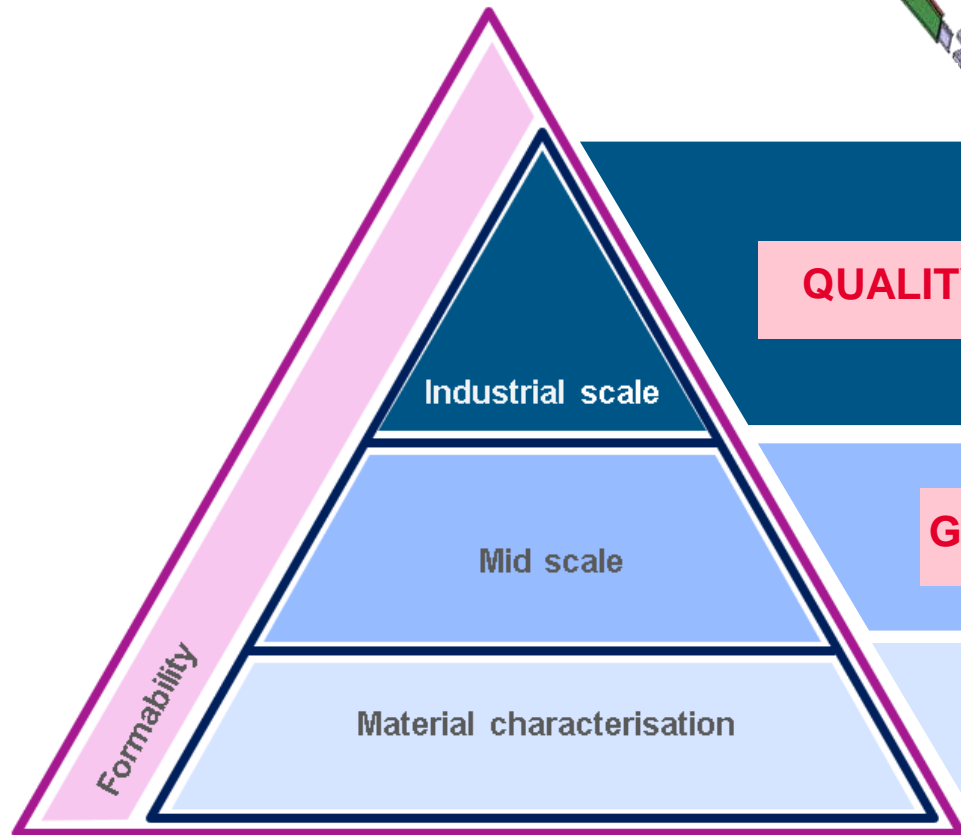

QUALITY NOT QUANTIFIED

GLOBAL FEATURES NOT TESTED

INACCURATE BOUNDARY CONDITIONS

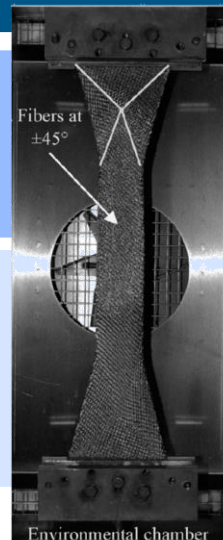

The untapped potential of shop floor photos

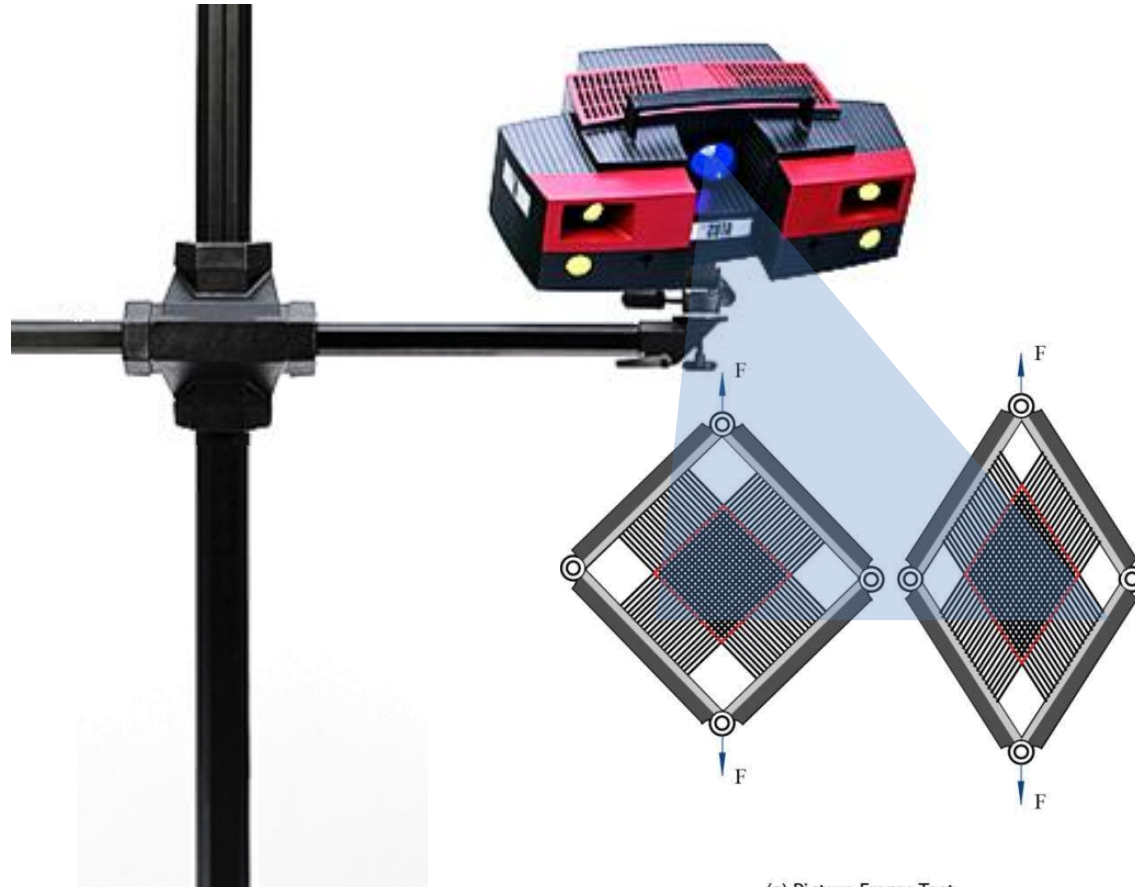

(a) Picture Frame Test

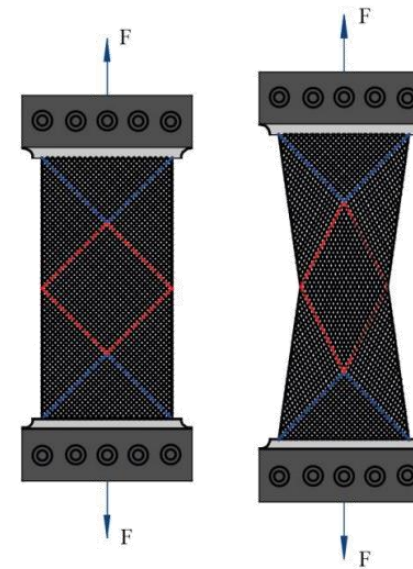

(b) Bias Extension Test

The untapped potential of shop floor photos

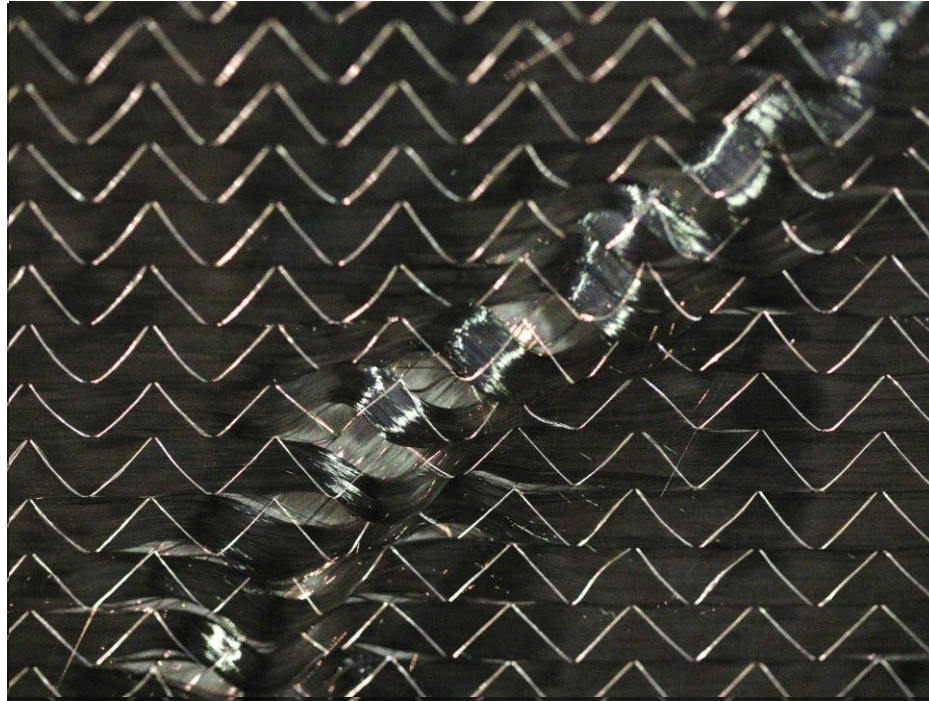

The untapped potential of shop floor photos

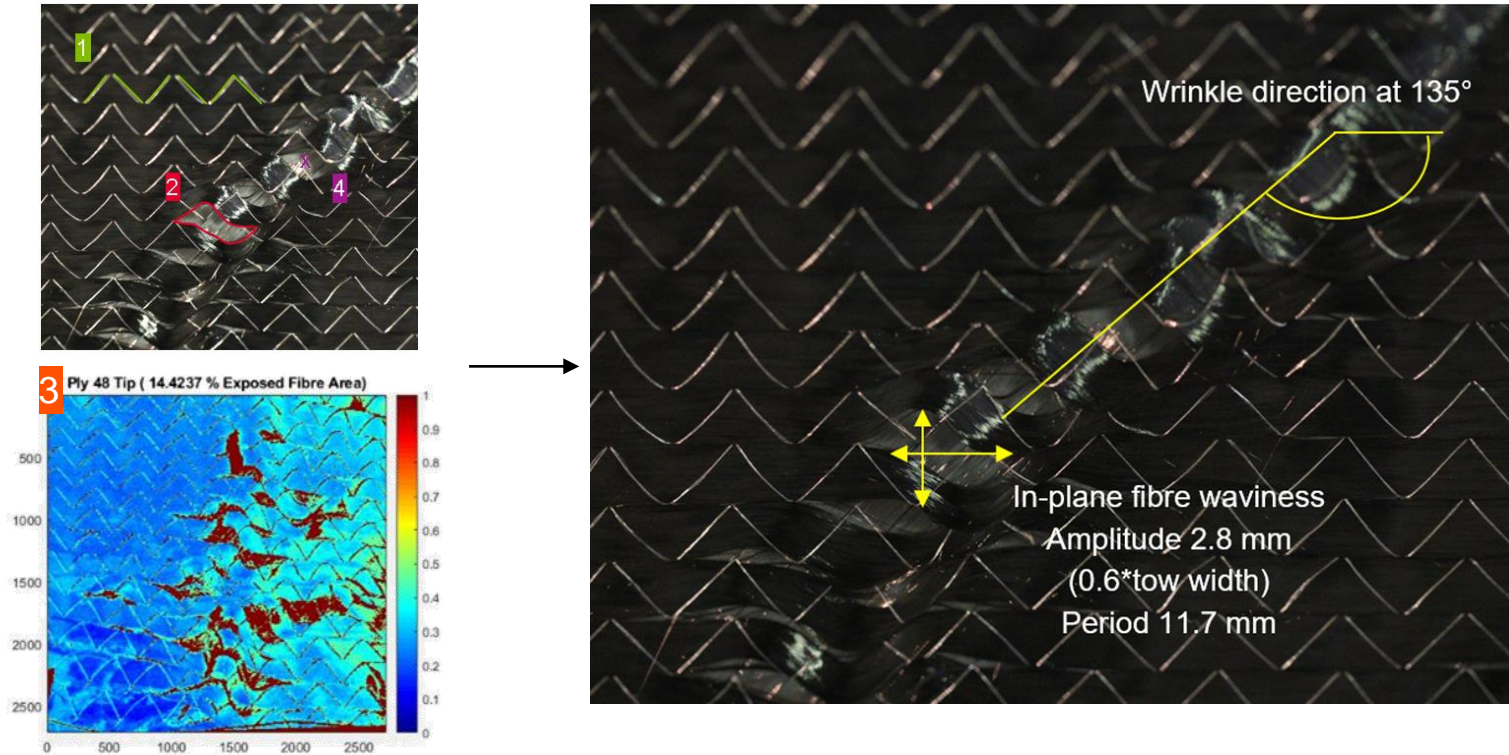

The untapped potential of shop floor photos

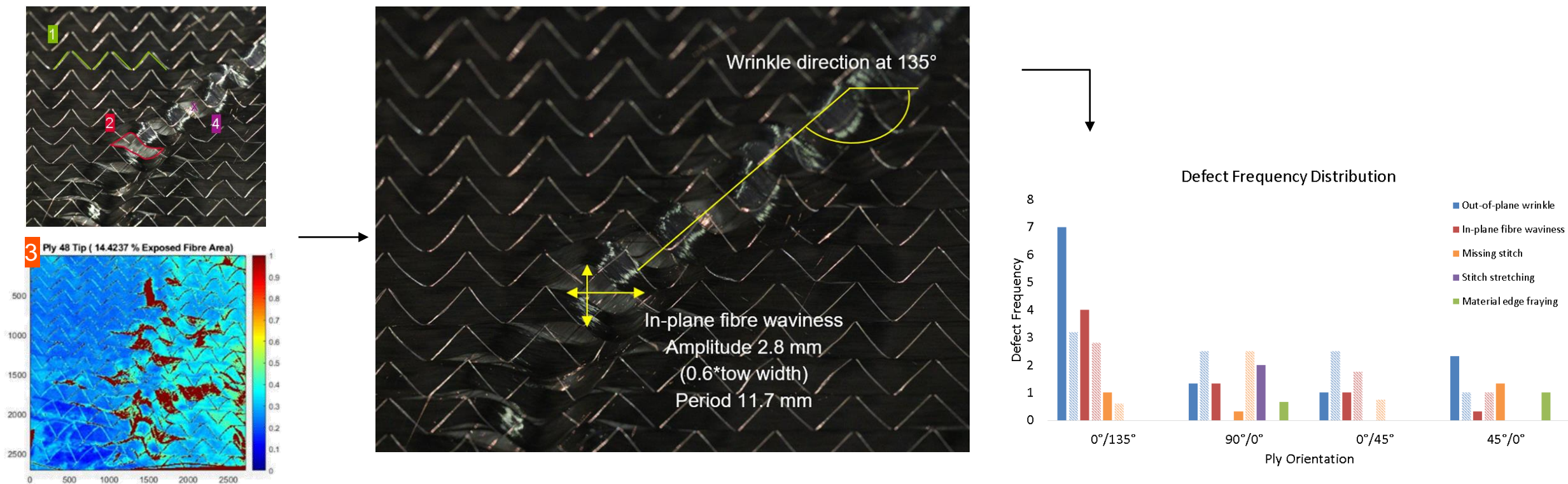

The untapped potential of shop floor photos

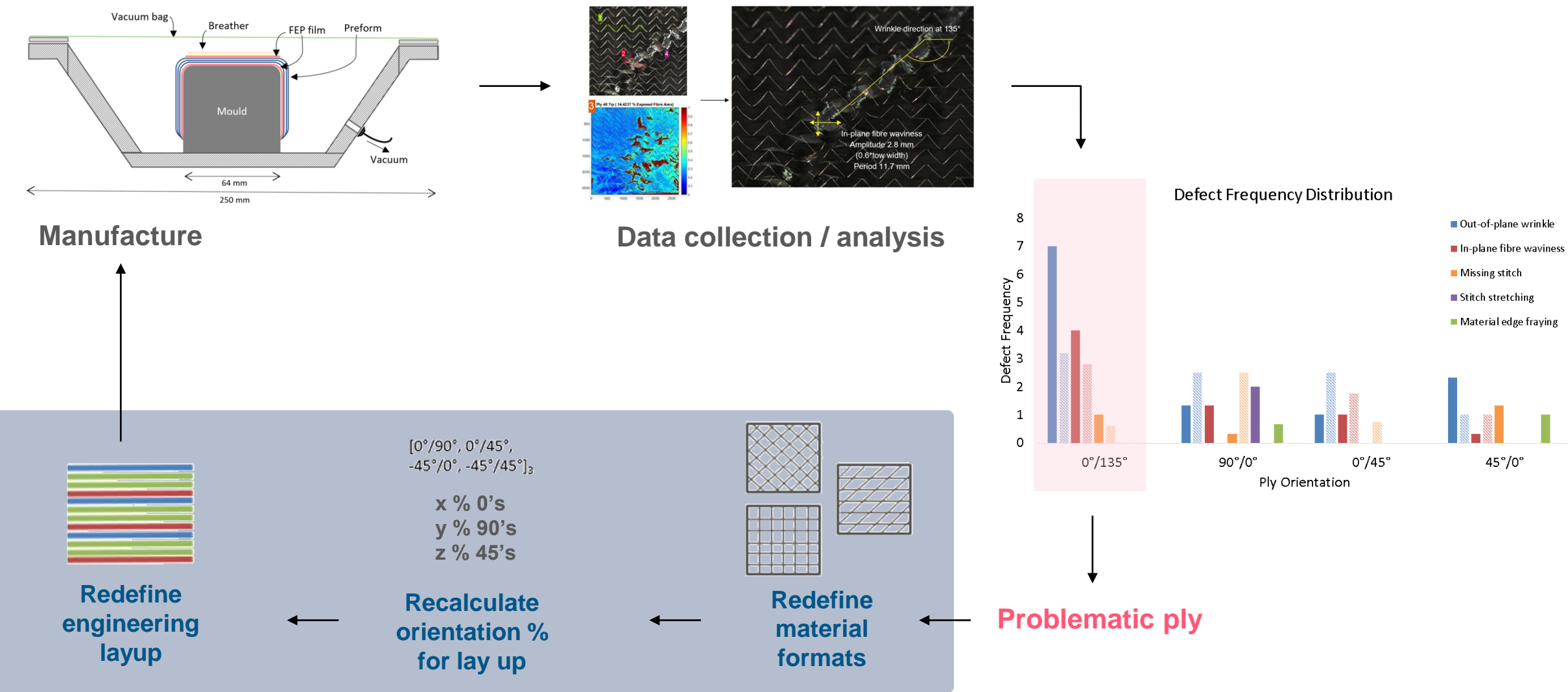

The untapped potential of shop floor photos

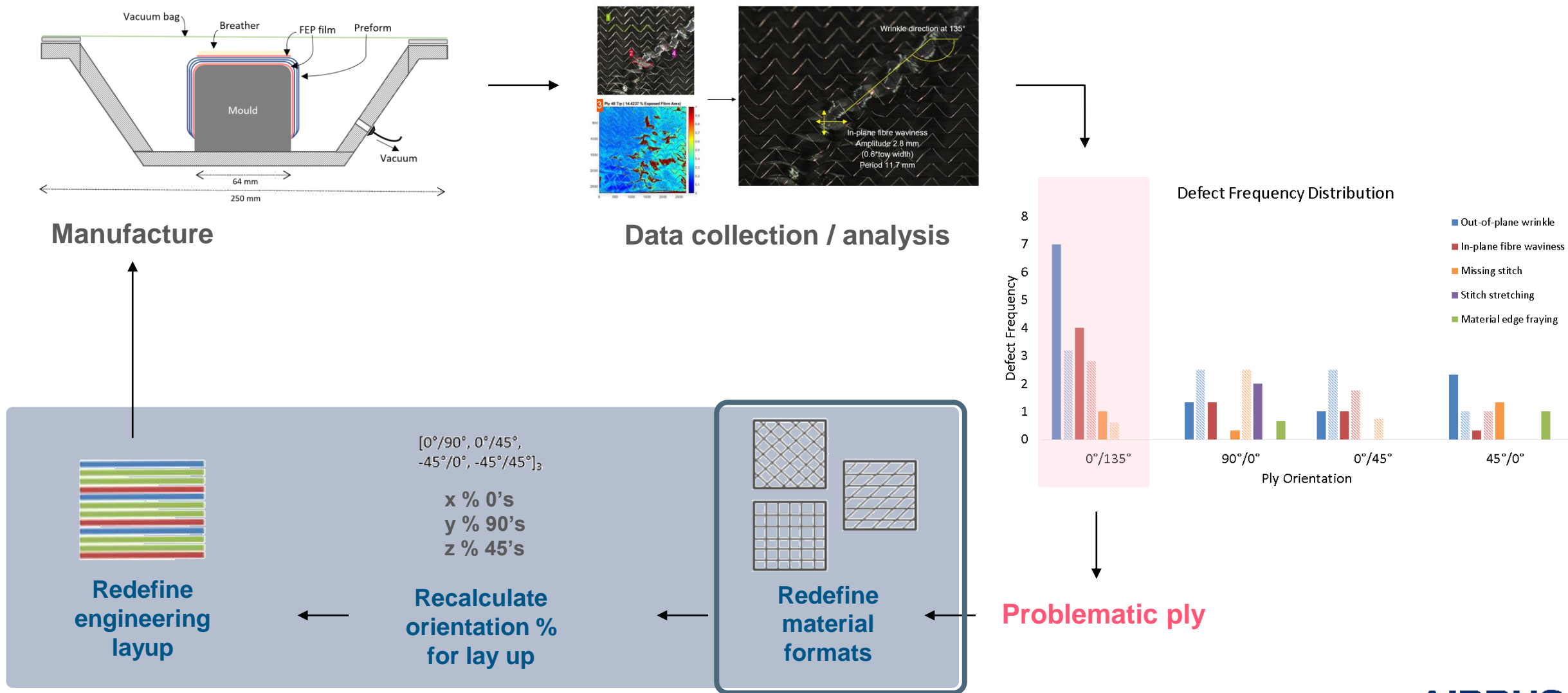

The untapped potential of shop floor photos

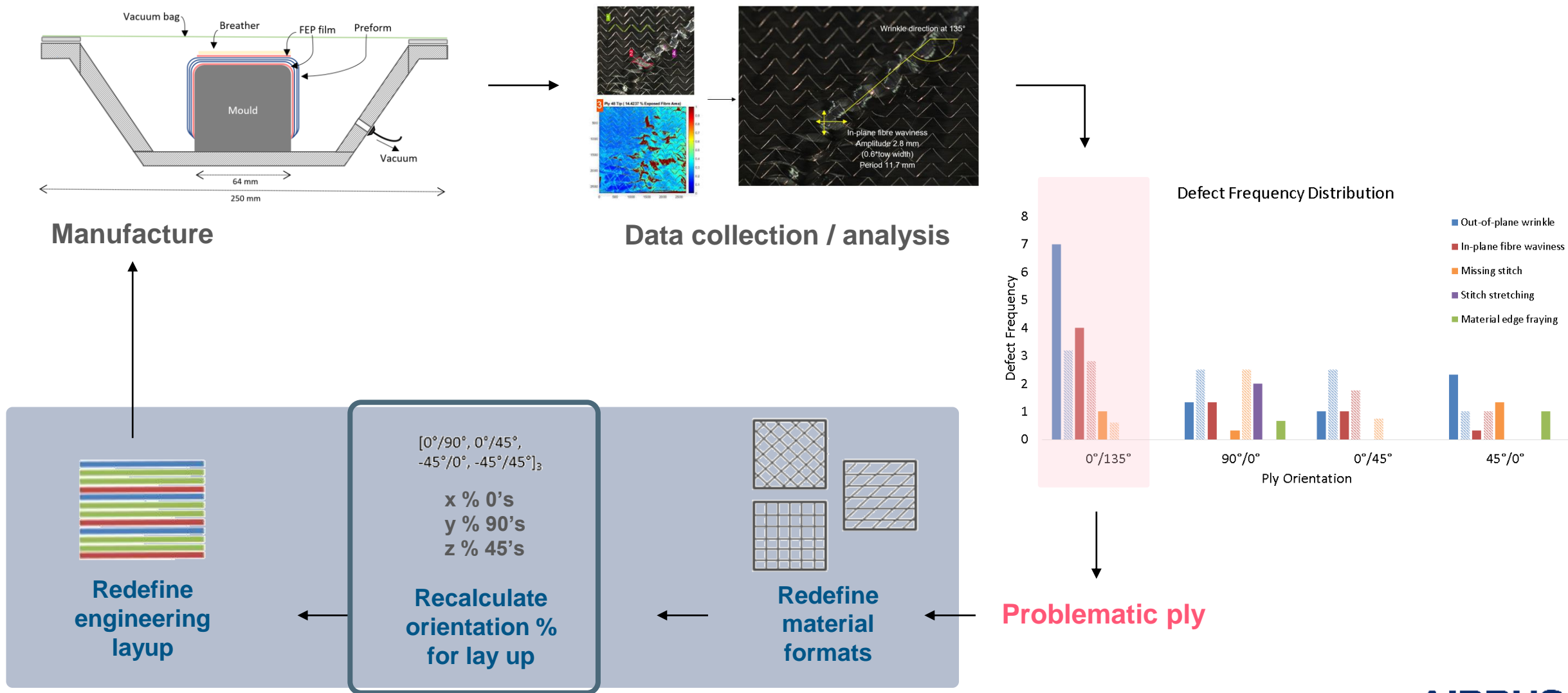

The untapped potential of shop floor photos

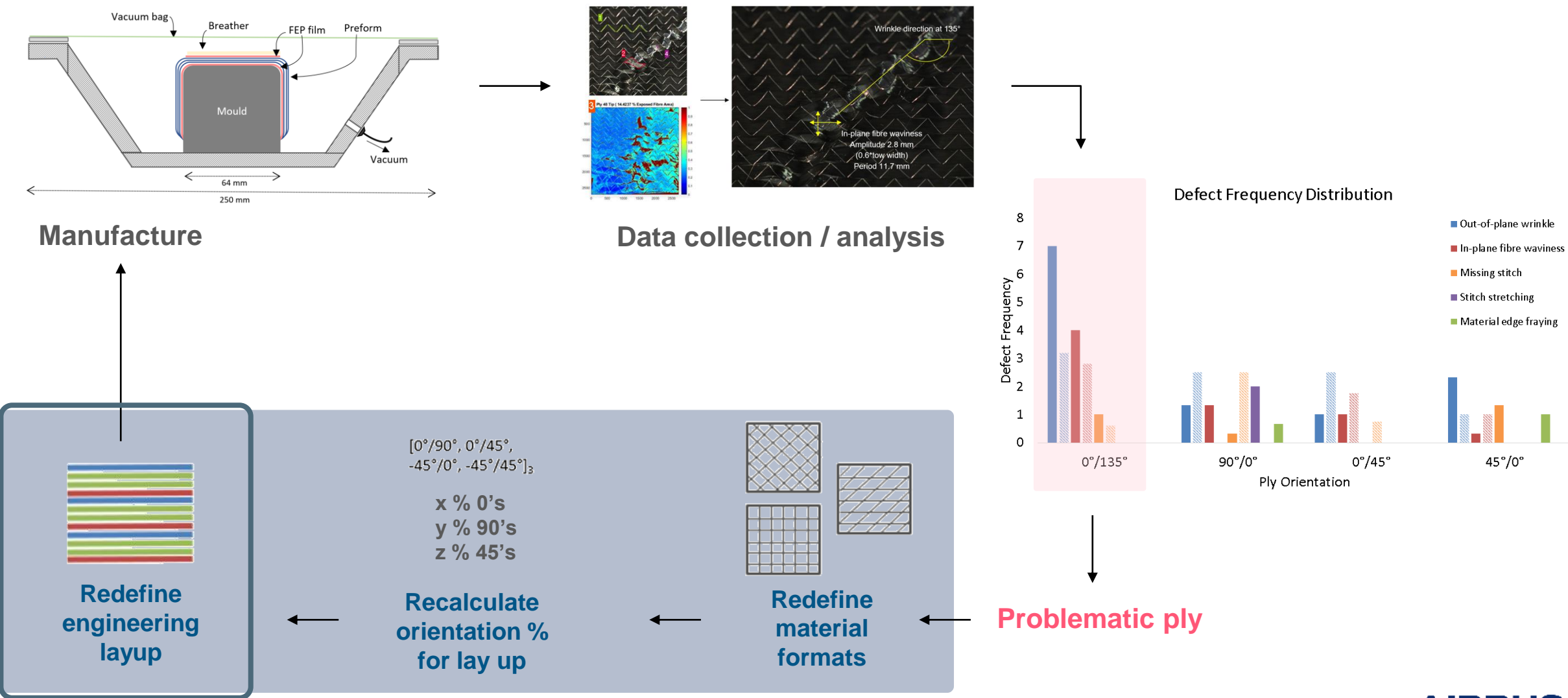

The untapped potential of shop floor photos

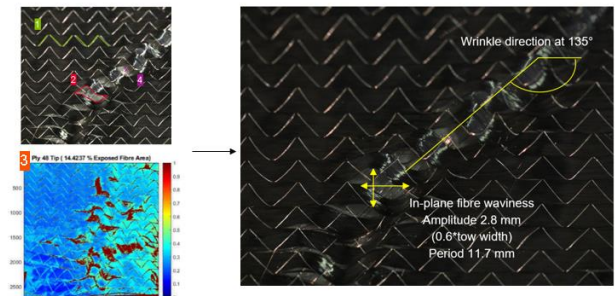
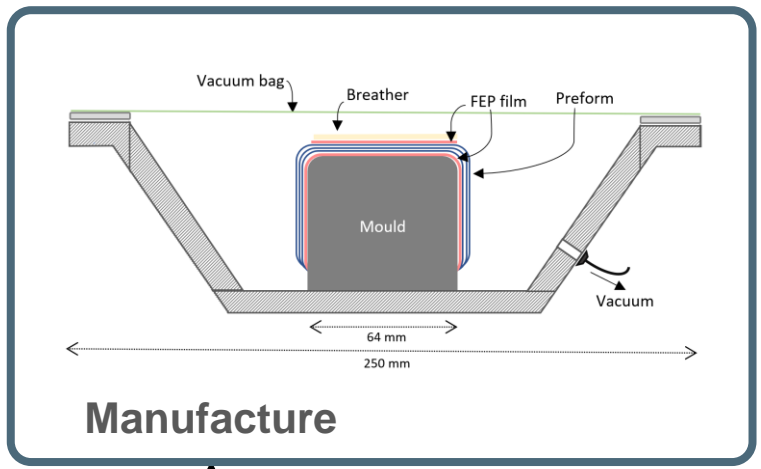

Data collection / analysis

Design for manufacture loop

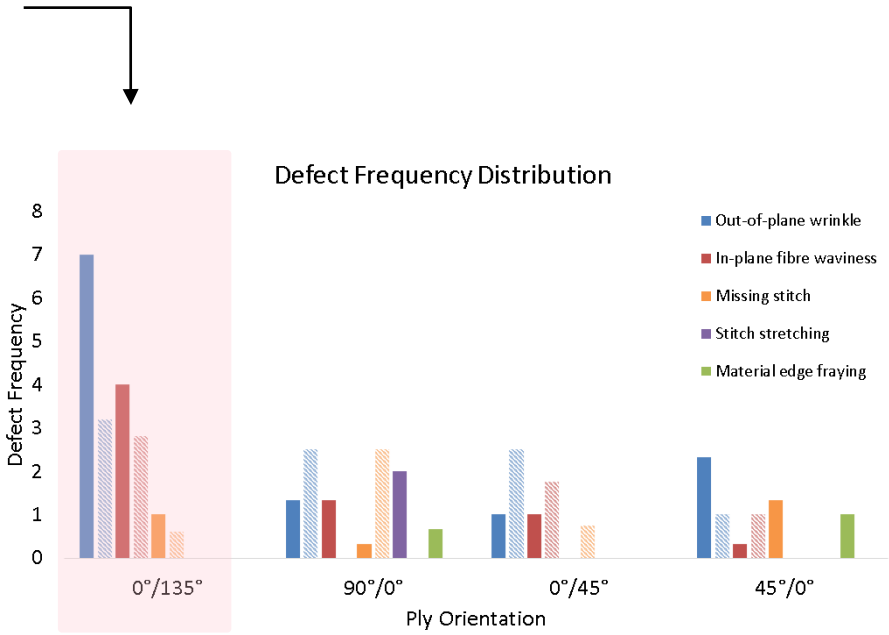
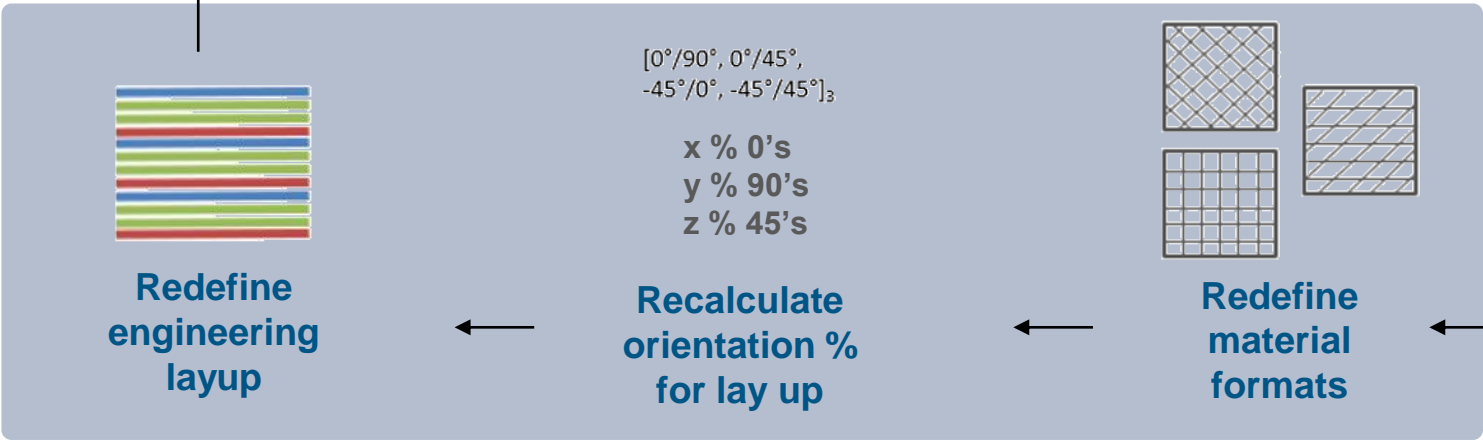

Problematic ply

The untapped potential of shop floor photos

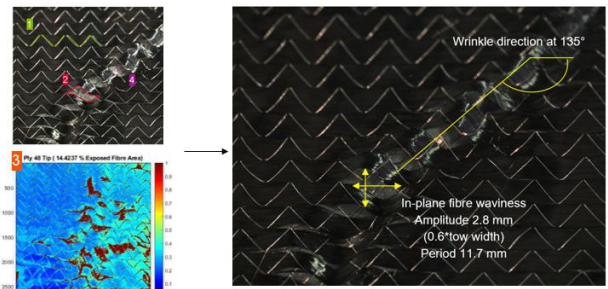
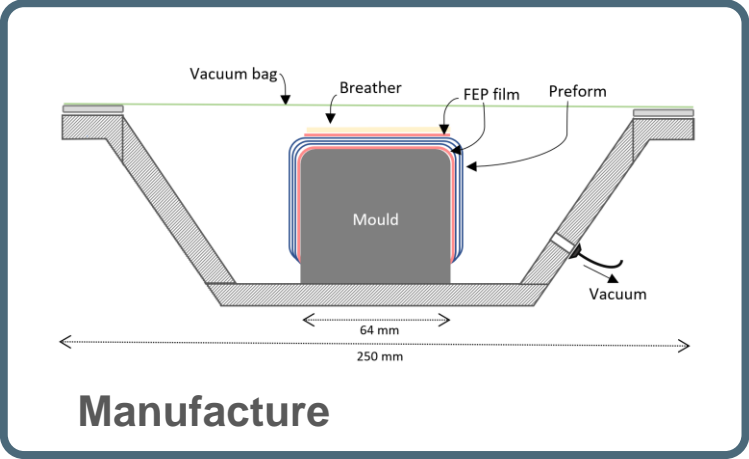

Data collection / analysis

Design for manufacture loop

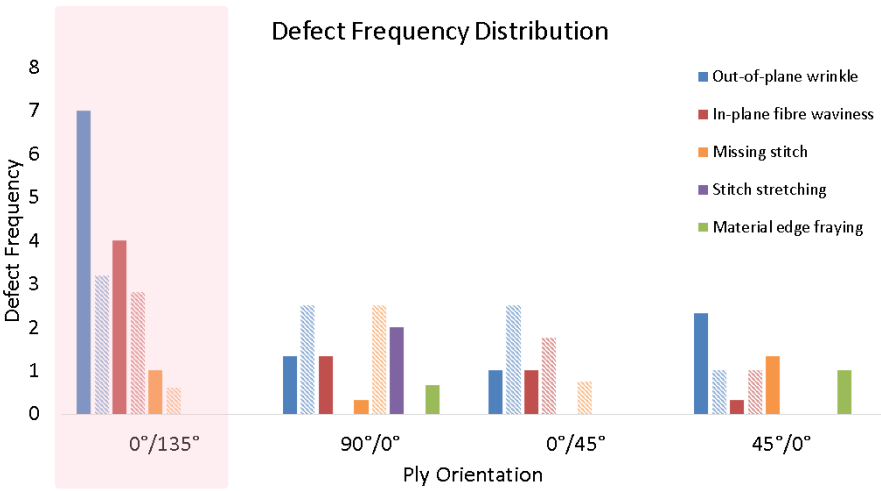
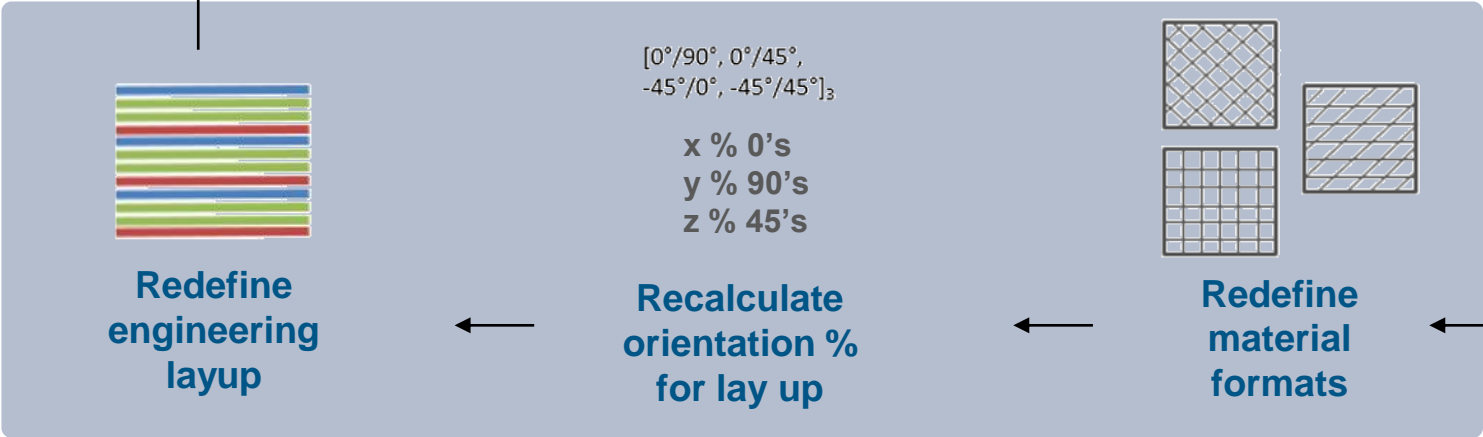

Problematic ply

Outcomes

- Value added insights
- Compatible across scales

Thank you