

# Arts and Social Sciences Library

## Ground Floor

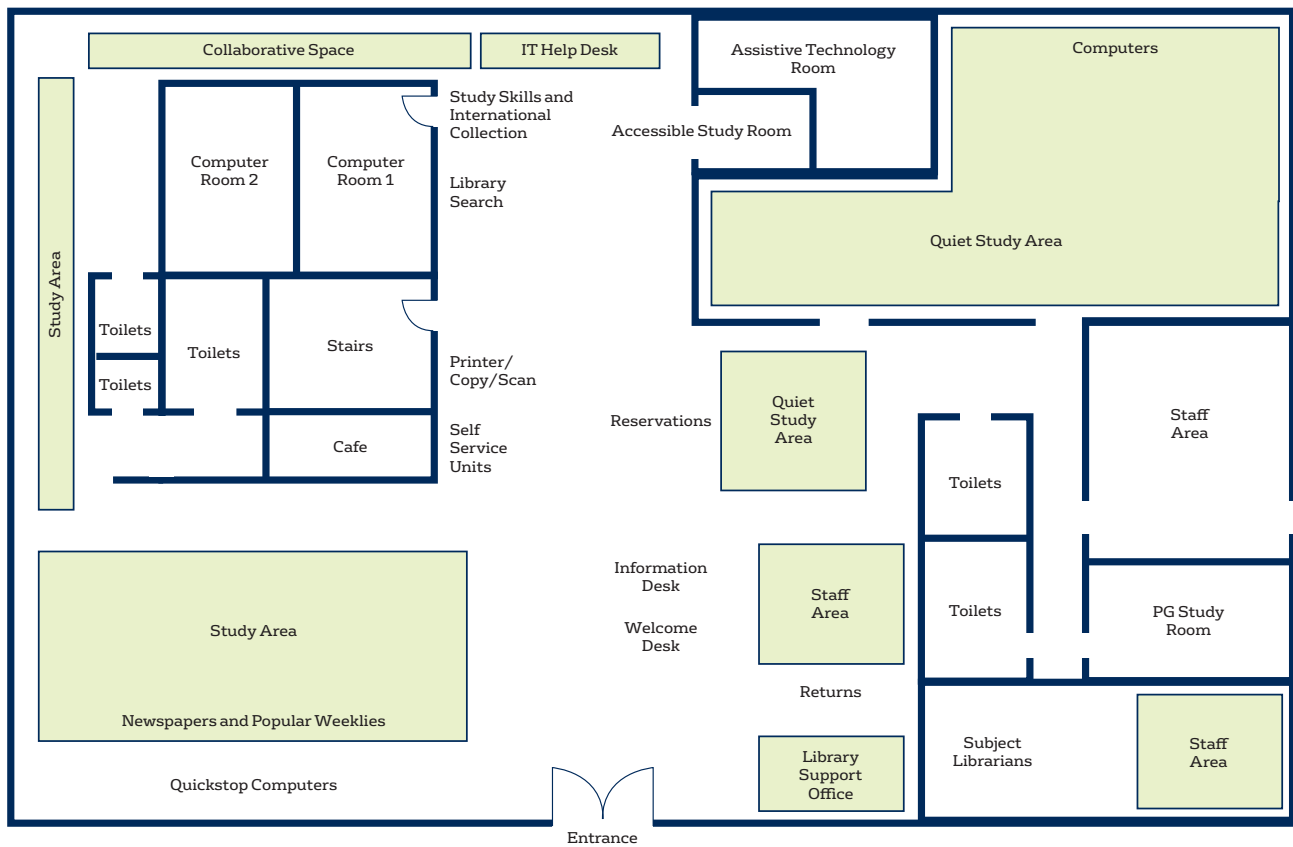

# Arts and Social Sciences Library

## First Floor

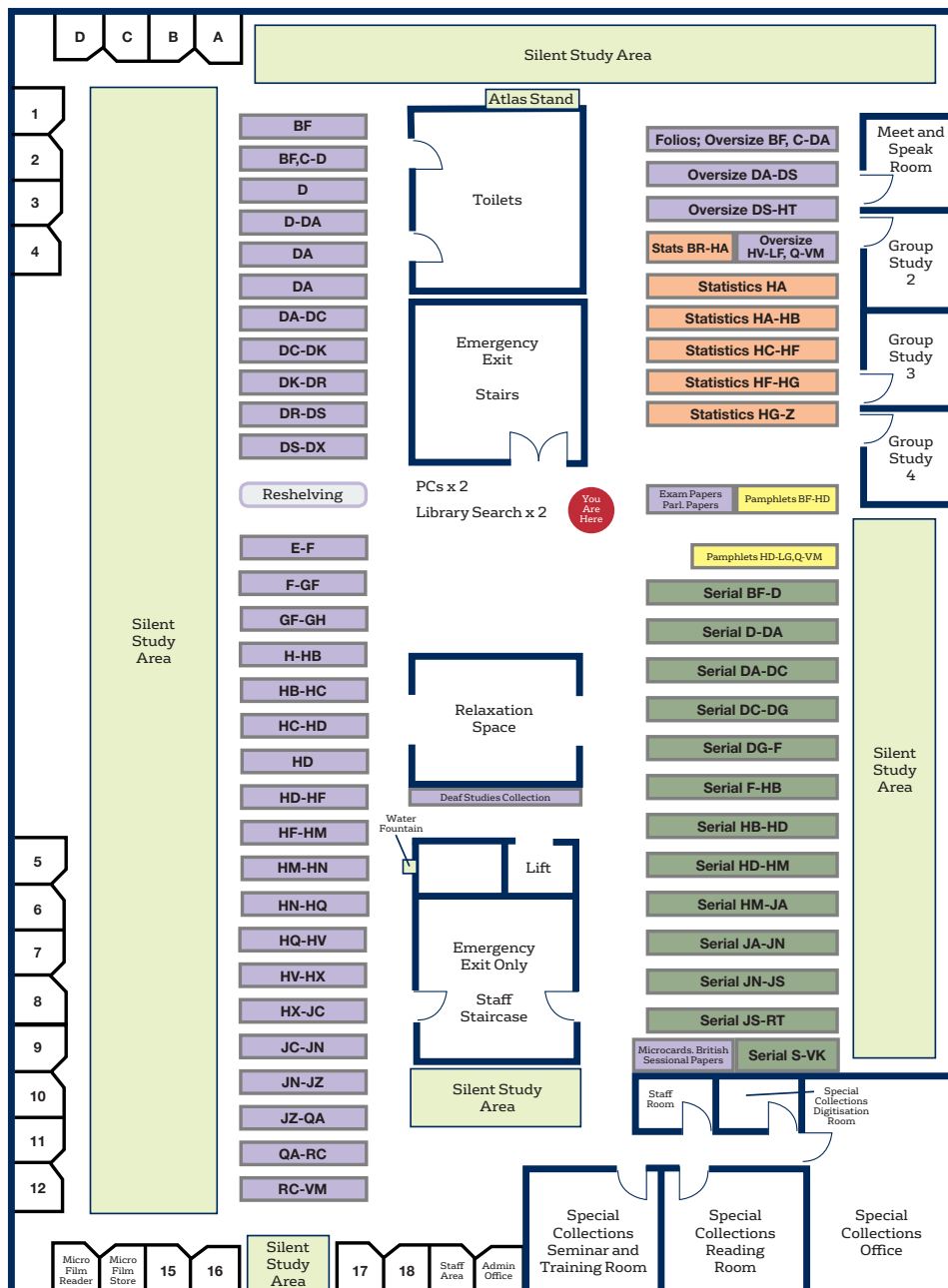

# Arts and Social Sciences Library

## Second Floor

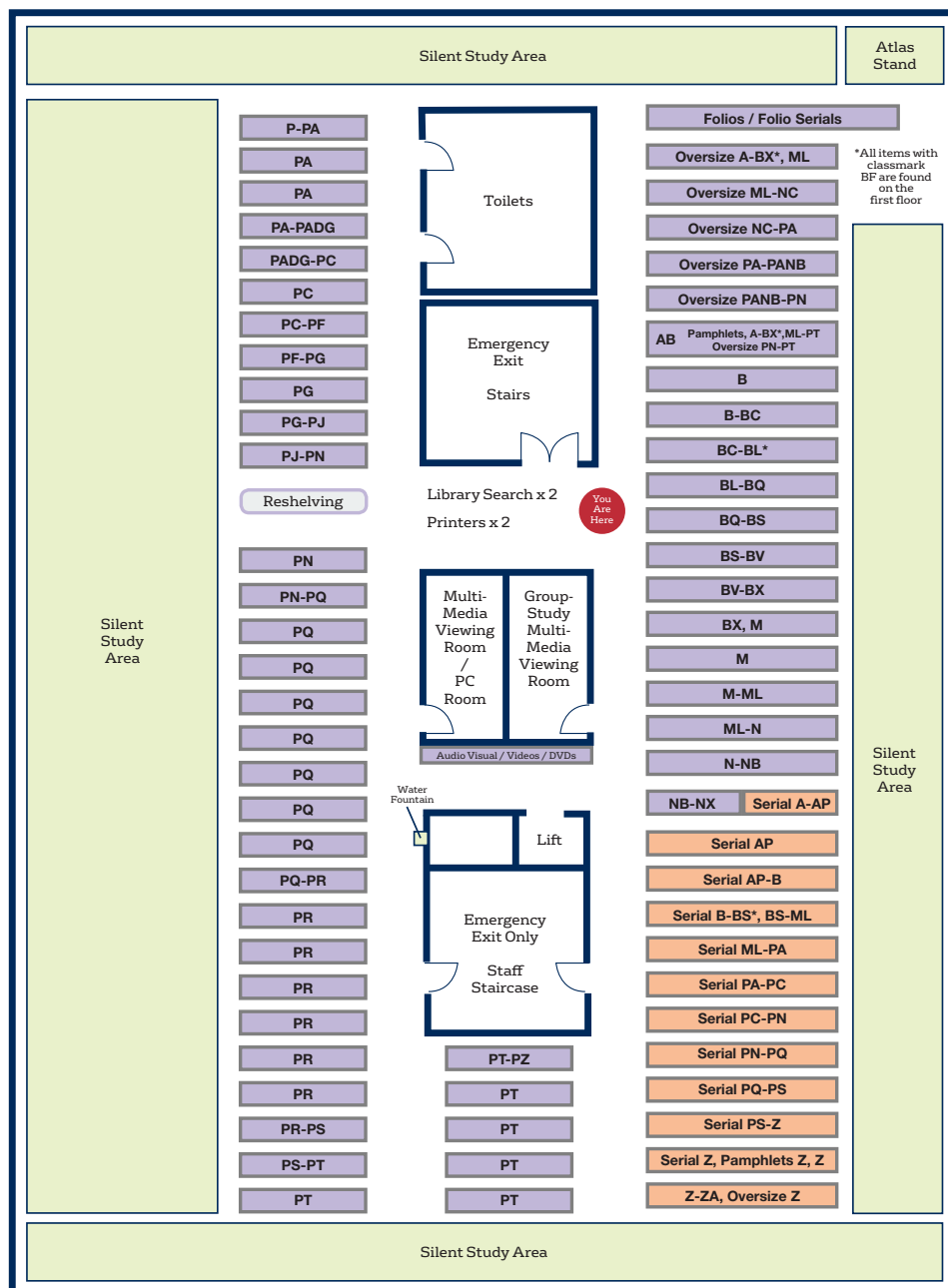

A summary of the class-marks used to organise books, journals and other printed material appears below.

For more specific locations within these broad class-marks consult Library Search.

<b>Classmark</b>	<b>Subject</b>	<b>Floor</b>
<b>A</b>	<b>General works</b>	<b>2</b>
<b>B-BD, BH-BX</b>	<b>Philosophy, Religion and Theology</b>	<b>2</b>
<b>BF</b>	<b>Psychology</b>	<b>1</b>
<b>C-CT</b>	<b>Archaeology, Genealogy, Numismatics, Biography</b>	<b>1</b>
<b>D-DX</b>	<b>General history, European, Middle Eastern, Asian, African, Australasian history</b>	<b>1</b>
<b>E-F</b>	<b>History of the Americas</b>	<b>1</b>
<b>G-GV</b>	<b>Geography, Anthropology</b>	<b>1</b>
<b>H-HX</b>	<b>Social sciences, Finance, Management</b>	<b>1</b>
<b>J-JZ</b>	<b>Political science, International Relations</b>	<b>1</b>
<b>K-KW</b>	<b>Law</b>	<b>1</b>
<b>L-LT</b>	<b>Education</b>	<b>1</b>
<b>M-MT</b>	<b>Music</b>	<b>2</b>
<b>N-NX</b>	<b>Fine arts (including Architecture)</b>	<b>2</b>
<b>P-PT</b>	<b>Linguistics, Languages, Literatures (inc PABF-PANX – ancient Greek/Roman history)</b>	<b>2</b>
<b>Q-QR</b>	<b>Science</b>	<b>1</b>
<b>R-RZ</b>	<b>Medicine</b>	<b>1</b>
<b>S-SK</b>	<b>Agriculture</b>	<b>1</b>
<b>T-TX</b>	<b>Engineering, Photography</b>	<b>1</b>
<b>U-UH</b>	<b>Military science</b>	<b>1</b>
<b>V-VM</b>	<b>Naval science</b>	<b>1</b>
<b>Z-ZA</b>	<b>Bibliography, Information science</b>	<b>2</b>
<b>Restricted</b>	<b>Special Collections</b>	<b>Basement</b>